

Client Detail with Addl Pics Report

Listings as of 02/27/10 at 1:05pm

Active 02/19/10	Listing # 21391518 County: Riverside	73691 De Anza Way Palm Desert, CA 92260-3611 Cross St: San Pasqual	Listing Price: \$159,900 Map: 848, F1	
	Prop Type	Residential	Prop Subtype(s)	Single Fam Res Detch
	Area	324-Palm Desert East	Subdivision	Not in a Development
	Beds	2	Approx SqFt	1960
	Baths	2	Price/Sq Ft	\$81.58
	Year Built	1951	Lot Sq Ft (approx)	10890
	APN	627153003	Lot Acres (approx)	0.250



Directions Highway 111 to San Pablo turn north, turn east on DeAnza

Public Marketing Remark This property is located on a corner lot across from the park. This property has a lot of potential. You'll feel great getting this one before anyone else does. This is the one you have been waiting to make an offer on.

Publication Info.

Rent/Lease	Yes		
Additional Property Features			
Lot #	1	School District	Other
Horse Property	No	Fireplace	Yes
Garage	None	Den/Office	No
Formal Dining Room	No	Family Room	Yes
Air Conditioning	Yes	Pool	No
Spa	No	Roof	Composition
Sewer	Unknown	Residence Descrip.	One Level
Unit Location	Ground Floor		
Special Circumstances			
REO/Bank Owned	Yes	Terms	Cash, Cash to New Loan
Land	Fee	Furnished	No

Presented By:	Alvin Greenwalt Jr Lic: 01715823 Primary: 760-310-1166 Secondary: 760-770-6801 Other: E-mail: alvin@alvingreenwalt.com Web Page: http://www.alvingreenwalt.com	Windermere Real Estate Lic: 01325548 71-691 Highway 111 Rancho Mirage, CA 92270 760-770-6801 See our listings online: http://www.windermerecoachellavalley.com
 February 2010		

All information herein has not been verified and is not guaranteed.
Copyright ©2010 Rapattoni Corporation. All rights reserved.



Client Detail with Addl Pics Report

Listings as of 02/27/10 at 1:05pm

Active 10/19/09	Listing # 21380373 County: Riverside	75220 Vista Huerto Palm Desert, CA 92211-9018 Cross St: Via Cinta/Hovley Lan	Listing Price: \$169,900 Map: 818, J5
------------------------	-------------------------------------------------------	-----------------------------------------------------------------------------------------------	--------------------------------------------------------



Prop Type	Residential	Prop Subtype(s)	Single Fam Res Detch
Area	324-Palm Desert East	Subdivision	Vista Del Montana
Beds	3	Approx SqFt	1184 Assessor
Baths	2	Price/Sq Ft	\$143.50
Year Built	1980	Lot Sq Ft (approx)	2614 ((Assessor))
APN	632042017	Lot Acres (approx)	0.060

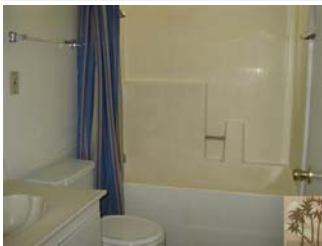

Public Marketing Remark Centrally located in the beautiful gated community of Vista Del Montana. Property features 3 bedrooms and 2 baths, large living room with fireplace, two car attached garage and a patio that faces the greenbelt. The Vista Del Montana community has two pools, two spas, tennis court and walking paths.

Publication Info.

Rent/Lease No

Association Features

Association Features Homeowners Assoc, Assoc Maint/Lndscp'g, Assoc Pool, Assoc Tennis

Lot / Community Description

Lot/Community Desc CC&R's, Gated Community

Additional Property Features

Lot #	68	School District	Desert Sands Unified
Horse Property	No	Fireplace	Yes
Fireplace Location	Living Room	Garage	Double
Garage Description	Attached	Floors	Ceramic Tile, Wall to Wall Carpet
Den/Office	Yes (3rd bedroom)	Formal Dining Room	No
Eat Area	Breakfast Nook	Family Room	No
Living Room	Yes	Heating Type	Forced Air
Air Conditioning	Yes	AC Type	Central
Laundry	Inside	Patio	Yes
Patio Type	Concrete Slab	Pool	Yes
Pool Location	Community	Pool Type	In Ground
Spa	Yes	Spa Description	Community
Roof	Spanish Clay Tile	Sewer	In Connected & Paid
Water Source	District	Residence Descrip.	One Level
Unit Location	Not Applicable		
Financial Information			
Trnsfr of Possession	Close of Escrow	Terms	Cash, Cash to New Loan, FHA Loan
Special Circumstances		Assoc Dues #1	\$300.00
REO/Bank Owned	Yes		
Land	Fee		
Furnished	No		

	Presented By:	Alvin Greenwalt Jr Lic: 01715823 Primary: 760-310-1166 Secondary: 760-770-6801 Other:	Windermere Real Estate Lic: 01325548 71-691 Highway 111 Rancho Mirage, CA 92270 760-770-6801 See our listings online:
	February 2010	E-mail: alvin@alvingreenwalt.com Web Page: http://www.alvingreenwalt.com	http://www.windermerecoachellavalley.com

All information herein has not been verified and is not guaranteed.
Copyright ©2010 Rapattoni Corporation. All rights reserved.



Client Detail with Addl Pics Report

Listings as of 02/27/10 at 1:05pm

Active 02/17/10	Listing # 21390950 County: Riverside	73950 Olive Ct Palm Desert, CA 92260-2951 Cross St: Portola	Listing Price: \$172,500 Map: 818, G7
------------------------	-------------------------------------------------------	------------------------------------------------------------------------------	--------------------------------------------------------



Prop Type	Residential	Prop Subtype(s)	Single Fam Res Detch
Area	322-Palm Desert N.	Subdivision	Not in a Development
Beds	4	Approx SqFt	1405
Baths	2.50	Price/Sq Ft	\$122.78
Year Built	1993	Lot Sq Ft (approx)	2614
APN	627123008	Lot Acres (approx)	0.060

Directions Crossing Portola and Catalina

Public Marketing Remark You cannot beat this great Palm Desert location. 4 bedrooms, new carpet and paint and close to everything. This property is corporate owned and sold in current condition. No repairs, warranties, disclosures or inspections provided by the seller. Your proof of funds or a prequalification letter from Wells Fargo must accompany all offers. Where there is a loan, it is not required that it be from Wells Fargo but it is required that it be from a direct lender. Please also provide proof of down payment or gift letter. A special addendum will be made part of the final contract.

Publication Info.

Rent/Lease	No		
Additional Property Features			
Lot #	8	School District	Desert Sands Unified
Horse Property	No	Fireplace	Yes
Garage	Double	Den/Office	No
Formal Dining Room	No	Family Room	No
Air Conditioning	Yes	Pool	No
Spa	No	Roof	Concrete Tile
Sewer	Unknown	Residence Descrip.	Two Levels
Unit Location	Not Applicable		
Special Circumstances			
REO/Bank Owned	Yes	Terms	Cash, Cash to New Loan
Land	Fee	Furnished	No

Presented By:	Alvin Greenwalt Jr Lic: 01715823 Primary: 760-310-1166 Secondary: 760-770-6801 Other: E-mail: alvin@alvingreenwalt.com Web Page: http://www.alvingreenwalt.com	Windermere Real Estate Lic: 01325548 71-691 Highway 111 Rancho Mirage, CA 92270 760-770-6801 See our listings online: http://www.windermerecoachellavalley.com
----------------------	---------------------------------------------------------------------------------------------------------------------------------------------------------------------------------------------------------------------------------------------------------------------------------------	-------------------------------------------------------------------------------------------------------------------------------------------------------------------------------------------------------------------------------------------------------



February 2010

All information herein has not been verified and is not guaranteed.
Copyright ©2010 Rapattoni Corporation. All rights reserved.



Client Detail with Addl Pics Report

Listings as of 02/27/10 at 1:05pm

Active 01/21/10	Listing # 21388513 County: Riverside	77050 Florida Ave Palm Desert, CA 92211-7755 Cross St: Tennessee	Listing Price: \$173,800 Map: 819, D7
------------------------	-----------------------------------------	---------------------------------------------------------------------	------------------------------------------



Prop Type	Residential	Prop Subtype(s)	Single Fam Res Detch
Area	324-Palm Desert East	Subdivision	Palm Desert Country
Beds	3	Approx SqFt	1736
Baths	2	Price/Sq Ft	\$100.12
Year Built	1965	Lot Sq Ft (approx)	6098
APN	637262006	Lot Acres (approx)	0.140

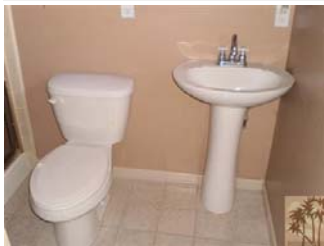

Directions Turn north on Tennessee off of Fred Waring Drive. Immediately turn right on Florida and the house will be on your left.
Public Marketing Remark A captivating home from the minute you drive up to it. This move-in ready home has a lot of alluring mid-century modern features. It is located on the fairway with expansive views. The interior features a living room plus a large great room. Corporate owned, buyer must be prequalified to include verification of income, credit and source of funds.

Publication Info.	
Rent/Lease	No
Association Features	
Association Features	Homeowners Assoc
Building Description	
Building Description	Freestanding
Interior / Exterior	
Interior/Exterior	Driveway

Lot / Community Description

Lot/Community Desc CC&R's
Golf Mem Available Yes

Golf Course in Dev. Yes

Special Features & View

View Golf Course View

Additional Property Features

Lot # 233
Horse Property No

School District Assessments Desert Sands Unified
 Special Assessments (\$370.96/year paid with taxes)

Fireplace Yes
Garage Single
Foundation Concrete Slab
Den/Office No
Eat Area Area, Brkfast Counter/Bar
Heating Type Forced Air
AC Type Central
Patio Type Concrete Slab
Spa No
Sewer Connected on Bond
Sprinklers Front & Rear
Residence Descrip. One Level
Unit Faces North

Fireplace Location Great Room
Garage Description Attached
Floors Ceramic Tile, Wall to Wall Carpet
Formal Dining Room No
Family Room Yes
Air Conditioning Yes
Laundry Individual Room
Pool No
Roof Other
Water Source District
Auto Timer Yes
Unit Location Not Applicable

Financial Information

Trnsfr of Possession Close of Escrow

Special Circumstances

REO/Bank Owned Yes
Land Fee
Furnished No

Terms Cash, Cash to New Loan
Assoc Dues #1 \$300.00

Presented By:**Alvin Greenwalt Jr****Windermere Real Estate**

Lic: 01715823
 Primary: 760-310-1166
 Secondary: 760-770-6801
 Other:

Lic: 01325548
 71-691 Highway 111
 Rancho Mirage, CA 92270
 760-770-6801

See our listings online:

E-mail: alvin@alvingreenwalt.com
 Web Page: <http://www.alvingreenwalt.com>

<http://www.windermerecoachellavalley.com>

February 2010

All information herein has not been verified and is not guaranteed.
 Copyright ©2010 Rapattoni Corporation. All rights reserved.



Client Detail with Addl Pics Report

Listings as of 02/27/10 at 1:05pm

Active 02/19/10	Listing # 21391158 County: Riverside	43115 Tennessee Ave Palm Desert, CA 92211-7762 Cross St: Florida	Listing Price: \$178,000 Map: 819, C6
------------------------	-------------------------------------------------------	-----------------------------------------------------------------------------------	--------------------------------------------------------



Prop Type	Residential	Prop Subtype(s)	Single Fam Res Detch
Area	324-Palm Desert East	Subdivision	Palm Desert Country
Beds	2	Approx SqFt	1238
Baths	2	Price/Sq Ft	\$143.78
Year Built	1979	Lot Sq Ft (approx)	6098
APN	637402013	Lot Acres (approx)	0.140



Directions Florida to Tennessee

Public Marketing Remark Great 2 bedroom Pool Home. Kitchen has had some upgrades and most of the house opens to the yard and pool with lovely southern views. New carpet and paint and ready for new owner

Publication Info.

Rent/Lease	No		
Lot / Community Description			
Golf Course in Dev.	Yes (PDCC)	Golf Mem Available	Yes
Special Features & View			
View	Mountain View		
Additional Property Features			
Lot #	54	School District	Desert Sands Unified
Horse Property	No	Fireplace	No
Garage	Double	Garage Description	Attached
Yard	Yes	Floors	Ceramic Tile, Wall to Wall Carpet
Den/Office	No	Formal Dining Room	No
Eat Area	Brkfast Counter/Bar	Family Room	No
Living Room	Yes	Entry	Yes
Heating Type	Forced Air	Air Conditioning	Yes
AC Type	Central	Laundry	In Garage
Patio	Yes	Patio Type	Concrete Slab
Pool	Yes	Pool Location	Private
Pool Type	In Ground	Spa	Yes
Spa Description	Private	Roof	Rock/Stone
Sewer	In Connected & Paid	Sprinklers	Front & Rear
Residence Descrip.	One Level	Unit Location	Not Applicable
TV Services	Cable		
Financial Information			
Trnsfr of Possession	Close of Escrow		
Special Circumstances			
REO/Bank Owned	Yes	Terms	Cash, Cash to New Loan
Land	Fee	Assoc Dues #1	\$1.00 (waiting on written conf if in PDCC HOA)
Furnished	No		

Presented By:



February 2010

Alvin Greenwalt Jr

Lic: 01715823
Primary: 760-310-1166
Secondary: 760-770-6801
Other:

E-mail: alvin@alvingreenwalt.com
Web Page: <http://www.alvingreenwalt.com>

Windermere Real Estate

Lic: 01325548
71-691 Highway 111
Rancho Mirage, CA 92270
760-770-6801

See our listings online:

<http://www.windermerecoachellavalley.com>

All information herein has not been verified and is not guaranteed.
Copyright ©2010 Rapattoni Corporation. All rights reserved.



Client Detail with Addl Pics Report

Listings as of 02/27/10 at 1:05pm

Active 01/01/10	Listing # 21386778 County: Riverside	74433 Fairway Dr Palm Desert, CA 92260-4944 Cross St: Deep Canyon	Listing Price: \$179,900 Map: 848, H2
------------------------	-------------------------------------------------------	------------------------------------------------------------------------------------	--------------------------------------------------------



Prop Type	Residential	Prop Subtype(s)	Single Fam Res Detch
Area	323-Palm Desert S.	Subdivision	Not in a Development
Beds	3	Approx SqFt	1474
Baths	2	Price/Sq Ft	\$122.05
Year Built	1951	Lot Sq Ft (approx)	7841
APN	625216001	Lot Acres (approx)	0.180



Directions Deep Canyon, right on Fairway

Public Marketing Remark Bank owned *Just reduced \$20,000* S Palm Desert 3 bed 2 bath with pool and nice views

Publication Info.

Rent/Lease No
Special Features & View
View Mountain View

Additional Property Features

Lot # 148
Horse Property No
Fireplace Location Great Room
Parking Description Parking Space
Formal Dining Room No
Air Conditioning Yes
Pool Yes
Pool Type In Ground
Spa Description In Ground
Sewer Unknown
Unit Location Ground Floor

School District Desert Sands Unified
Fireplace Yes
Garage None
Den/Office No
Family Room Yes
AC Type Central
Pool Location Private
Spa Yes
Roof Comp/Shingle
Residence Descrip. One Level

Special Circumstances

REO/Bank Owned Yes
Land Fee
Terms Cash, Cash to New Loan
Furnished No

Presented By:



Alvin Greenwalt Jr

Lic: 01715823
 Primary: 760-310-1166
 Secondary: 760-770-6801
 Other:

E-mail: alvin@alvingreenwalt.com
 Web Page: <http://www.alvingreenwalt.com>

Windermere Real Estate

Lic: 01325548
 71-691 Highway 111
 Rancho Mirage, CA 92270
 760-770-6801

See our listings online:

<http://www.windermerecoachellavalley.com>

February 2010

All information herein has not been verified and is not guaranteed.
 Copyright ©2010 Rapattoni Corporation. All rights reserved.



Client Detail with Addl Pics Report

Listings as of 02/27/10 at 1:05pm

Active 01/17/10	Listing # 21388097 County: Riverside	74121 Desert Star Blvd Palm Desert, CA 92260-2614 Cross St: Portola Ave	Listing Price: \$179,900 Map: 818, G7
------------------------	-------------------------------------------------------	------------------------------------------------------------------------------------------	--------------------------------------------------------



Prop Type	Residential	Prop Subtype(s)	Single Fam Res Detch
Area	322-Palm Desert N.	Subdivision	Not in a Development
Beds	4	Approx SqFt	1827
Baths	2	Price/Sq Ft	\$98.47
Year Built	1969	Lot Sq Ft (approx)	9583
APN	624194006	Lot Acres (approx)	0.220



Public Marketing Remark Bank Owned! What a great opportunity for a first time home buyer, an investor, or someone wanting a vacation retreat here in the desert. Please come and tour this wonderful home today. NOTE: will not qualify for FHA financing.

Publication Info.

Rent/Lease	No	School District	Other
Additional Property Features		Fireplace	No
Lot #	25	Garage Description	Attached
Horse Property	No	Den/Office	No
Garage	Double	Family Room	No
Foundation	Concrete Slab	Pool	Yes
Formal Dining Room	No	Pool Type	In Ground
Air Conditioning	Yes (unknown if operational)		
Pool Location	Private		

Spa	No	Roof	Comp/Shingle
Sewer	In Connected & Paid (buyer to verify)	Residence Descrip.	One Level
Unit Location	Not Applicable		
Special Circumstances			
REO/Bank Owned	Yes	Terms	Cash, Cash to New Loan (NO FHA OFFERS PLEASE)
Land	Fee	Furnished	No

Presented By:



Alvin Greenwalt Jr

Lic: 01715823
 Primary: 760-310-1166
 Secondary: 760-770-6801
 Other:

E-mail: alvin@alvingreenwalt.com
 Web Page: <http://www.alvingreenwalt.com>

Windermere Real Estate

Lic: 01325548
 71-691 Highway 111
 Rancho Mirage, CA 92270
 760-770-6801

See our listings online:

<http://www.windermerecoachellavalley.com>

February 2010

All information herein has not been verified and is not guaranteed.
 Copyright ©2010 Rapattoni Corporation. All rights reserved.



Client Detail with Addl Pics Report

Listings as of 02/27/10 at 1:05pm

Active 12/22/09	Listing # 41385968 County: Riverside	77115 Florida Ave Palm Desert, CA 92211-7746 Cross St: Tennessee	Listing Price: \$189,900 Map: 819, D7	
	Prop Type	Residential	Prop Subtype(s)	Single Fam Res Detch
	Area	324-Palm Desert East	Subdivision	Palm Desert Country
	Beds	3	Approx SqFt	1348 Assessor
	Baths	2	Price/Sq Ft	\$140.88
	Year Built	1989	Lot Sq Ft (approx)	6098 ((Assessor))
	APN	637263010	Lot Acres (approx)	0.140

Directions From Fred Waring, enter off Tennessee, then make a right onto Florida Avenue

Public Marketing Remark *REO* This 3 bedroom 2 bath home with a pool and spa is across the street from the 6th fairway of the golf course.

Publication Info.

Rent/Lease	No		
Association Features			
Association Features	Homeowners Assoc		
Lot / Community Description			
Lot/Community Desc	CC&R's	Golf Course in Dev.	Yes
Golf Mem Available	Yes		
Special Features & View			
View	Mountain View		
Additional Property Features			
Lot #	218	School District	Coachella Valley Uni
Horse Property	No	Fireplace	Yes
Garage	Double	Enclosed	Block Wall
Floors	Ceramic Tile	Den/Office	No
Formal Dining Room	No	Eat Area	In Kitchen
Family Room	No	Heating Type	Forced Air
Air Conditioning	Yes	AC Type	Central
Laundry	In Garage	Dryer Hookup	Electric
Pool	Yes	Pool Location	Private
Pool Type	Gunite, In Ground	Spa	Yes
Spa Description	Private, In Ground	Roof	Spanish Clay Tile
Sewer	In Connected & Paid	Water Source	District
Residence Descrip.	One Level	Unit Location	Ground Floor
Special Circumstances			
REO/Bank Owned	Yes	Terms	Cash, Cash to New Loan, Submit
Land	Fee	Furnished	No

Presented By:	Alvin Greenwalt Jr Lic: 01715823 Primary: 760-310-1166 Secondary: 760-770-6801 Other:	Windermere Real Estate Lic: 01325548 71-691 Highway 111 Rancho Mirage, CA 92270 760-770-6801 See our listings online:
	E-mail: alvin@alvingreenwalt.com Web Page: http://www.alvingreenwalt.com	http://www.windermerecoachellavalley.com
February 2010		

All information herein has not been verified and is not guaranteed.
Copyright ©2010 Rapattoni Corporation. All rights reserved.



Client Detail with Addl Pics Report

Listings as of 02/27/10 at 1:05pm

Active 01/25/10	Listing # 21388775 County: Riverside	77160 Florida Ave Palm Desert, CA 92211-7738 Cross St: Elkhorn	Listing Price: \$192,000 Map: 819, D7	
	Prop Type	Residential	Prop Subtype(s)	Single Fam Res Detch
	Area	324-Palm Desert East	Subdivision	Palm Desert Country
	Beds	3	Approx SqFt	2042
	Baths	2	Price/Sq Ft	\$94.03
	Year Built	1965	Lot Sq Ft (approx)	6098
	APN	637262017	Lot Acres (approx)	0.140

Directions North on Elkhorn Tr from Fred Waring. Left on Florida.

Public Marketing Remark Mid Century Modern home in a fabulous golf course location with expansive fairway and mountain views. Partially converted garage (permit status unknown). This property is corporate owned and sold in current condition. No repairs, warranties, disclosures or inspections (including termite) provided by the seller. Your proof of funds or a prequalification letter from a direct lender must accompany all offers. A special addendum will be made part of the final contract.

Publication Info.

Rent/Lease No

Association Features

Association Features Homeowners Assoc

Lot / Community Description

Lot/Community Desc On The Golf Course

Special Features & View

View Golf Course View, Panoramic View, Mountain View

Additional Property Features

Lot # 244

Horse Property No

Garage Single

Formal Dining Room No

Air Conditioning Yes

Spa No

Sewer Unknown

Unit Location Not Applicable

Special Circumstances

REO/Bank Owned Yes

Land Fee

Furnished No

School District

Desert Sands Unified

Fireplace

Yes

Den/Office

Yes (Converted garage)

Family Room

No

Pool

No

Roof

Composition

Residence Descrip.

One Level

Terms

Cash, Cash to New Loan

Assoc Dues #1

\$336.00 (Buyer to verify)

Presented By:

Alvin Greenwalt Jr

Lic: 01715823

Primary: 760-310-1166

Secondary: 760-770-6801

Other:

E-mail: alvin@alvingreenwalt.com

Web Page: <http://www.alvingreenwalt.com>

Windermere Real Estate

Lic: 01325548

71-691 Highway 111

Rancho Mirage, CA 92270

760-770-6801

See our listings online:

<http://www.windermerecoachellavalley.com>



February 2010

All information herein has not been verified and is not guaranteed.
Copyright ©2010 Rapattoni Corporation. All rights reserved.



Client Detail with Addl Pics Report

Listings as of 02/27/10 at 1:05pm

Active 12/29/09	Listing # 21386310 County: Riverside	77095 Florida Ave Palm Desert, CA 92211-7737 Cross St: Tennessee/Fred Warin	Listing Price: \$199,900 Map: 819, D7
------------------------	-------------------------------------------------------	----------------------------------------------------------------------------------------------	--------------------------------------------------------



Prop Type	Residential	Prop Subtype(s)	Single Fam Res Detch
Area	324-Palm Desert East	Subdivision	Palm Desert Country
Beds	4	Approx SqFt	1648 Assessor
Baths	2.50	Price/Sq Ft	\$121.30
Year Built	1992	Lot Sq Ft (approx)	6970 ((Assessor))
APN	637263008	Lot Acres (approx)	0.160



Directions Tennessee/Fred Waring

Public Marketing Remark Rare to find 4 bd home in Palm Desert Country Club, great buy for a first time buyer, needs a little TLC but well worth it - Note the extra 1/2 bath - All walls (no wooden fences) and covered patio.

Publication Info.

Rent/Lease No

Additional Property Features

Lot # 220

Horse Property No

Garage Double

Den/Office No

Family Room No

Air Conditioning Yes

School District

Fireplace Yes

Garage Description Attached

Formal Dining Room No

Heating Type Forced Air

AC Type Central

Pool	No	Spa	No
Roof	Concrete Tile	Sewer	In Connected & Paid
Residence Descrip.	One Level	Unit Location	Not Applicable
Special Circumstances		Terms	Cash, Cash to New Loan
REO/Bank Owned	Yes	Assoc Dues #1	\$300.00 (per year)
Land	Fee		
Furnished	No		

Presented By:



Alvin Greenwalt Jr

Lic: 01715823
 Primary: 760-310-1166
 Secondary: 760-770-6801
 Other:

E-mail: alvin@alvingreenwalt.com
 Web Page: <http://www.alvingreenwalt.com>

Windermere Real Estate

Lic: 01325548
 71-691 Highway 111
 Rancho Mirage, CA 92270
 760-770-6801

See our listings online:

<http://www.windmererecoachellavalley.com>

February 2010

All information herein has not been verified and is not guaranteed.
 Copyright ©2010 Rapattoni Corporation. All rights reserved.

